



UNIVERSITY OF  
DELAWARE®

SPRING 2016 | February 23 – April 28

**Dover**

For adults 50+

*Curiosity has no age limit*



**5** *Beginning Conversational Spanish*



**9** *Nine Great Religions*



**11** *Art During World War II*

NEW THIS SPRING!

**7** *History of Aviation*

SPECIAL SESSION!

**Winter Lecture Series**

**January 26–February 16**

*The History of Painting with Watercolors*

*See page 2 for details.*

[www.lifelonglearning.udel.edu/dover](http://www.lifelonglearning.udel.edu/dover)



"This is a work of art,  
a great work  
of art...a work for  
eternity".

# Illuminating the Word

THE SAINT JOHN'S BIBLE



Art lovers, admirers of fine crafts and religious devotees alike will be captivated by this exhibit of 70 pages from The Saint John's Bible, the first hand illuminated Bible commissioned in over 500 years. Coming to Delaware for the first, and potentially only time before being bound, this modern work of art took 23 artists and calligraphers 15 years to produce. See the breathtaking artwork, view the artist's tools and learn the story of its creation. Interested in making your own illumination or learning calligraphy? This exhibition will be accompanied by a variety of workshops and programming. Visit our website for details.

Admission is \$10/\$8 for seniors/FREE for members.

December 4, 2015-  
March 27, 2016

Biggs Museum  
of American Art

406 Federal Street, Dover, DE  
302.674.2111  
www.BiggsMuseum.org

Detail from *The Four Horsemen of the Apocalypse (Revelation 6:1-8:14)*, Donald Jackson (artist, scribe).  
Copyright 2011, *The Saint John's Bible*, Saint John's University, Collegeville, Minnesota USA.  
\*Page Page Number XVI



Edgar A. Thronson  
Foundation

## Dover Art League

Downtown Dover  
Delaware  
21 West Lockerman Street  
Dover DE 19904  
302-674-0402  
Hours: Tuesday 12 pm-4 pm  
Wed-Friday 10am-4pm  
Saturday 10am to 2pm  
First Fridays 5pm-7pm



Come and enjoy Art  
unleash the  
artist in you!



facebook

Educational Classes & workshops  
available for all  
ages  
Children Summer  
Art Camps



# Osher Lifelong Learning Institute

at the University of Delaware in Dover

## Founding Committee

John Bochnowski • Charlie Burris  
Judy Diogo • Carolyn Fredericks  
Jack Gardner • Phyllis Handler  
Bob Heifetz • Larry Koch • Pat Payne  
Rich Phillips • Dave Skocik  
Daphne Strickland

## Council

**Chair:** Kevin McGrath  
**Vice Chair:** Jim Brown  
**Secretary:** Caroline Baxter  
**Members:** Ila Beebe • Betty Ipnar  
Art McLaughlin • Liisa Trala • Randy Ward  
Madelyn Wright

## University of Delaware Staff

James Broomall  
Associate Vice Provost, Professional  
and Continuing Studies  
Tim Plimpton  
Program Coordinator, Dover  
Diana Faison  
Administrative Assistant, Dover

## Curriculum Committee

**Chair:** Art McLaughlin  
Mike Apgar • George Christensen  
Beth Jelich • Doug Miller • Carol Neild

## Member Relations Committee

**Chair:** Cheryl Moore  
Caroline Baxter • Marge Felty  
Janice McGraw • Betty Ipnar  
Liz Langham • Jonette Oldham • Liisa Trala

## Public Relations Committee

**Chair:** *Vacant*  
Ila Beebe • Lawrence Klepner  
Jan Miller • Betsy Patterson

## Special Events Committee

**Chairs:** Rosemary Engle • Liisa Trala  
Marie Isenberg • Ann Kemmerle  
Connie Ragin

## Travel Committee

**Chairs:** Betsy Patterson • Madelyn Wright  
John Dacey • Julie Price  
Gene Modzelewski • Carole Winters



### About the cover:

Photo taken by Mary Elizabeth Phillips after the Dover Days Festival, May 2015. Historic Dover Days is considered by many to be the highlight of the spring season in Dover.

## Contents

Courses .....	4
Instructors .....	13
Registration Forms .....	17, 19
Maps/Directions .....	21

## Mission and Vision

The Osher Lifelong Learning Institute at the University of Delaware in Dover offers opportunities for intellectual development, cultural stimulation, personal growth and social interaction for people age 50+ in an educational cooperative.

Members volunteer their wealth of talent and experience in planning and implementing high quality educational experiences to form an educational cooperative. The members are the instructors and students, and through a committee structure guide the operating policies, develop curriculum and help with daily operations. No educational prerequisites are needed and there are no grades or exams—just learning for the fun of it.



Modern Maturity Center  
1121 Forrest Avenue • Dover, DE 19904

Phone: 302-736-7450 • Email: [LLL-dover@udel.edu](mailto:LLL-dover@udel.edu)  
[www.lifelonglearning.udel.edu/dover](http://www.lifelonglearning.udel.edu/dover)

The advertising in this booklet subsidizes the cost of printing. The University receives no profit from it, nor does the University endorse any of the products of the advertisers.

The University of Delaware is an equal opportunity/affirmative action employer. For the University's complete nondiscrimination statement, please visit <http://www.udel.edu/aboutus/legalnotices.html>.  
CEP 5829 11/15 Printed on recycled paper.

Cover photos: (background) Mary Elizabeth Phillips



# Osher Lifelong Learning Institute

at the University of Delaware in Dover

## General Information

### Membership

Membership is open to men and women at least 50 years of age and to members' spouses or partners at any age. Whether your formal education ended early in life or includes advanced degrees, we welcome you. An interest in learning is all that is required.

Members complete a registration form and pay the membership fee for the full year or the current semester. Single semester memberships expire on the first day of the subsequent semester, while full year memberships expire on September 1 of the following year. Full year memberships are only available for purchase during the fall semester.

### Fees

Single semester membership: \$130

Full year membership: \$225

Instructor discount: \$15 for each semester taught

With your membership, you may request to take as many courses as you like. The program depends almost entirely on membership fees, which are applied against operating expenses, including rent for the classroom spaces, office and classroom supplies, staff salaries and the cost of catalog printing and postage.

### Financial Assistance

Need-based partial scholarships are available. For scholarship information or an application, contact the office at 302-736-7450.

### Refunds

Membership fees will be refunded prior to the end of the second week of the semester. Refund requests must be submitted in writing to the Osher office. A \$15 processing charge will be deducted from all refund requests received after the first day of classes.

Trip and activity refund requests will only be accepted prior to the event and must be submitted in writing to the Osher office. Acceptance of refund requests will be granted based on the required minimum number of participants needed to cover the costs of the event. Once Osher has made final payments for trips and activities there will be no refunds.

Refunds may take up to six weeks to process. Questions should be directed to the Osher office.

## WINTER LECTURE SERIES

### The History of Painting with Watercolors

#### January 26 • 10–11:30 a.m.

The Early History and Technology of Watercolor Painting

#### February 2 • 10–11:30 a.m.

Watercolorists Better Known for Oil Painting

#### February 9 • 10–11:30 a.m.

Painters Primarily Known as Watercolorists

#### February 16 • 10–11:30 a.m.

The Watercolor and Tempera Paintings of the Wyeths

**The History of Painting with Watercolors** will begin with a presentation on the components of watercolor paints, techniques and tools used by watercolorists. History of the technique will cover paintings created from the time of prehistoric cave wall paintings up to the present day. Visual presentations will primarily feature landscapes, seascapes and cityscapes, the subjects favored by watercolorists over the history of the art form. Watercolor painting by artists such as Albrecht Dürer, William Blake, Georgia O'Keefe, Paul Klee, Andrew Wyeth and numerous contemporary American and European artists will be discussed. Class participation in discussions is encouraged.

This series will be presented by Osher member and local watercolorist Edwin Hoiles and Osher member and instructor Art McLaughlin.

### Winter Membership

The Winter Lecture Series is a program offered by the Osher Lifelong Learning Institute at the University of Delaware in Dover. Membership in the Osher Lifelong Learning Institute is open to anyone age 50+. A special winter membership (January-February) is required to attend the series.

### Fees

Winter membership—\$30

Winter add-on to spring membership—\$20

Winter add-on to full-year membership—\$10

### Registration Info (see page 17 to register by mail)

Registration for the winter series will be accepted beginning December 1 on a space available basis. Because seats are limited, early registration is encouraged. Registration is available online, by mail or in-person at the Dover office, 1121 Forrest Ave. Please call the office at 302-736-7450 ahead of time for in-person registration.

### Location

East Conference Room, Modern Maturity Center,  
1121 Forrest Ave, Dover, DE 19904

# Spring 2016 Course Schedule by Day

## TUESDAY

### Period 1 (9 a.m.–10:15 a.m.)

- AA115 Oil Painting—*Miller*  
(9 a.m.–11:45 a.m.)
- LA208 Let's Meet the French!—*Cataldi*  
(starts March 8)
- HX160 History of Aviation—*Hain*
- HX217 Selected Topics in Delaware  
History—*Bryan* (first five weeks)
- PA104 Fun with the Ukulele—*Blakey*  
(last five weeks)
- PS111 Our National Parks—Part II—  
*Jones* (no class April 5)

HU121 Issues in Constitutional Law, 9-10:30 a.m.

### Period 2 (10:30 a.m.–11:45 a.m.)

- LA207 French Cuisine—*Cataldi*  
(starts March 8)
- LS120 Writing Obituaries—*McKay*
- HU101 Images of Ideas—*The Greenes*
- PA116 Recorder Ensemble—*Neild*
- HX213 And the World Was Never the  
Same—*Jones* (no class April 5)

### Period 3 (1 p.m.–2:15 p.m.)

- HU242 The Poetics of Moby Dick—*Endo*  
(first five weeks)
- PS108 The Elephant Has Left the  
Building—*Christensen & Kotrch*
- HX214 China in WWII—*Apgar*
- AA112 Repurposed Painting—*Trala*  
(1 p.m.–3 p.m., first five weeks,  
at Dover Art League)
- SS155 How Your Body Works and How  
it Ages—*A. McLaughlin* (no class  
April 5, last session May 3)

- AA166 Open Studio—Multimedia—  
*Medunick* (1 p.m.–3:45 p.m.)

### Period 4 (2:30 p.m.–3:45 p.m.)

- CS110 21st Century Security—  
*S. McLaughlin* (first five weeks)
- LA115 Beginning Conversational  
Spanish—*Price* (last five weeks)
- AA160 Art During World War II—  
*A. McLaughlin* (no class April 5,  
last session May 3)



LARRY KLEPNER

## WEDNESDAY

- RR102 Chair Aerobics—*Miller*  
(starts March 2, 11 a.m.–12 p.m.)
- LS101 The Legacy of Lifelong Learning—  
*Plimpton* (first five weeks,  
1 p.m.–2 p.m.)
- SS110 The Aging Mind—*Magee*  
(last five weeks, 1 p.m.–3 p.m.)

### Offsite:

- HX153 The Golden Age of Music (first  
five weeks, 1 p.m.–2 p.m.)
- RR101 Exploring Bombay Hook  
(last five weeks, 10 a.m.–12 p.m.)
- HX151 Exploring the Heritage of the  
First State (last five weeks,  
1 p.m.–2 p.m.)

## THURSDAY

### Period 1 (9 a.m.–10:15 a.m.)

- AA131 Fundamentals of Drawing II—  
*Medunick & Miller*
- HU186 Nine Great Religions—*Cella*
- HX216 Washington's Crossing—*Jelich*  
(first five weeks)
- HU213 A Streetcar Named Desire—  
*Heifetz* (last five weeks)
- AA126 Colors and Cables—*Dunn*  
(ends April 14)
- LS140 Writer's Critique Workshop—  
*Johnston* (last five weeks)

### Period 2 (10:30 a.m.–11:45 a.m.)

- HU229 Conversations on Poetry—  
*Johnston* (last five weeks)
- AA134 Advanced Drawing—*Miller*
- EC121 Elder Law—*Grady* (first five  
weeks)
- HU121 Interesting Issues in  
Constitutional Law—*Boyd*  
RESCHEDULED  
to Tues (last five weeks)
- HU212 The Seven Deadly Sins—*Heifetz*
- AA173 Open Studio—Knitting—*Dunn*  
(ends April 14)
- HX211 The Assassination of JFK—  
*Pritchett*

### Period 3 (1 p.m.–2:15 p.m.)

- HU202 Talkin' Baseball II—*Ward*
- HX239 Unique Qualities of Delaware—  
*Baxter & Burton*  
CANCELED
- AA114 Intro to Watercolors—*Zehnter*
- PA118 Sing Along with Broadway  
Musicals—*Letavish*

### Period 4 (2:30 p.m.–3:45 p.m.)

- CS386 Computer Users Workshop—  
*Watkins*
- HX161 On the Home Front—*McGrath*
- PS121 How We Study Human  
Behavior—*Hazzard*

Unless noted otherwise, all courses are  
ten weeks in length: February 23–April 28  
First five weeks: February 23–March 24  
Last five weeks: March 29–April 28

# Spring 2016 Courses



## AA112 REPURPOSED PAINTING

Tuesdays, 1 p.m.–3 p.m.  
Dates: 5 Sessions, February 23–March 22  
Instructor: Liisa Trala

In this course, you will take plain pieces of glass and/or ceramic and turn them into “permanent” decorated useful pieces. You will make great one of a kind gifts for family, friends or even yourself! Classes will be held at the Dover Art League, 21 W. Loockerman Street in downtown Dover. **Class is limited to 15 students.**

★ *New!*

## AA114 INTRODUCTION TO WATERCOLORS

Thursdays, 1 p.m.–2:15 p.m.  
Dates: 10 Sessions, February 25–April 28  
Instructor: Andrew Zehnter

This class is for anyone who believes they can't paint watercolors. We will cover basic techniques such as creating a wash, layering colors, composition and much more. The instruction will consist of detailed landscapes using photographs. It is recommended that students have basic drawing skills. **Class is limited to 10 students.**

## AA115 OIL PAINTING

Tuesdays, 9 a.m.–11:45 a.m.  
Dates: 10 Sessions, February 23–April 26  
Instructor: Jan Miller

This class is for intermediate and experienced painters. It will cover techniques, and the use of challenging subjects will encourage growth in painting skills and experience. We will have ample time to paint in a relaxed

## Volunteer Opportunities

As an educational cooperative, the success of the program depends on engaged and enthusiastic volunteers. Members are encouraged to offer new course ideas, serve as instructors and serve on committees in support of the program. Active participation in the lifelong learning program is an excellent way to develop new friendships and be part of an exciting and dynamic learning community.



To volunteer, please complete the “Volunteer Opportunities” section on the course selection form, or contact the Dover program coordinator at 302-736-7450, Modern Maturity Center, 1121 Forrest Avenue, Dover, 19904 or email [LLL-dover@udel.edu](mailto:LLL-dover@udel.edu).

atmosphere. Prerequisites for this class are color and composition and drawing. Personal supplies may need additions on an as needed basis. A list of supplies will be distributed. Approximate supply cost will be \$40. **Class is limited to 14 students.**

★ *New!*

## AA126 COLORS AND CABLES

Thursdays, 9 a.m.–10:15 a.m.  
Dates: 8 Sessions, February 25–April 14  
Instructor: Kathleen Dunn

This course will introduce participants to the basics of knitting in the round with two circular needles, making cables and stranding colors when knitting with two yarns one at a time. Participants should be comfortable knitting, purling, casting on and binding off. It will be helpful if you know how to do increases or decreases. Participants will each complete a cabled fingerless mitten with a cable and thumb as well as a watch cap in two or more colors. The second fingerless mitten can be completed at home or in class for additional practice as time permits. This class will be hands-on with individual assistance as needed. While working on learning and improving

knitting skills the class will discuss the history and approaches to both cabled and stranded knitting in different cultures. Resources for assistance while not in class will be provided. **Class is limited to 10 students.**

## AA131 FUNDAMENTALS OF DRAWING II

Thursdays, 9 a.m.–10:15 a.m.  
Dates: 10 Sessions, February 25–April 28  
Instructors: Jan Miller and Linda Medunick

A continuation of the world of drawing, honing the basic skills from previous instruction. Course will utilize live models, still life subjects and reproduction of photos in pencil. **Class is limited to 14 students.**

★ *New!*

## AA134 ADVANCED DRAWING

Thursdays, 10:30 a.m.–11:45 a.m.  
Dates: 10 Sessions, February 25–April 28  
Instructor: Jan Miller

Progressive class combining issues of importance to the students with their skills as artists to create works of art. **Class is limited to 15 students.**





## Scholarship Fund

It is the intent of the Osher Lifelong Learning Institute to extend the program to all adults over 50 years of age in the greater Dover community who desire to continue the pursuit of knowledge in their individual areas of interest. We rely on contributions to continue this commitment. You are invited to consider a tax-deductible gift to the scholarship fund with your registration.

### AA160 ART DURING WORLD WAR II

Tuesdays, 2:30 p.m.–3:45 p.m.

Dates: 10 Sessions, February 23–March 29, April 12–May 3

Instructor: Art McLaughlin

This course will explore a notorious chapter of WWII history, the looting of art by the Nazis. We will examine questions regarding why the art was stolen, the artistic background of Hitler and his associates and Nazi art theory. We will look at Nazi art, examine the role of art in Nazi propaganda and how the Nazis were so successful in stealing art. This will be discussed in the framework of the Western history of looting art, both in Europe and in the United States. Finally, we will look at the policies of Russia relative to looted art during WWII. **Class is limited to 50 students.**

### AA166 OPEN STUDIO—MULTIMEDIA

Tuesdays, 1 p.m.–3:45 p.m.

Dates: 10 Sessions, February 23–April 26

Instructor: Linda Medunick

This course is designed for students of fine art to receive additional instruction and dedicate time to work on ongoing projects. Students can complete unfinished works, start new projects, work independently and practice new medium techniques. Students work in media of their choice and the instructor and other classmates will be available for guidance.

### AA173 OPEN STUDIO—KNITTING

Thursdays, 10:30 a.m.–11:45 a.m.

Dates: 8 Sessions, February 25–April 14

Instructor: Kathleen Dunn

This course is designed for beginner through advanced knitters to work on projects or practice techniques with the support of an instructor. This is a good opportunity to get back to unfinished projects that have lingered in your knitting bag because you don't know what to do next or how to fix a problem. The instructor can also provide support for those wishing to try out a new technique or unfamiliar project. Participants will need to provide their own materials, tools and patterns. May be taken concurrently with Colors and Cables. **Class is limited to 20 students.**

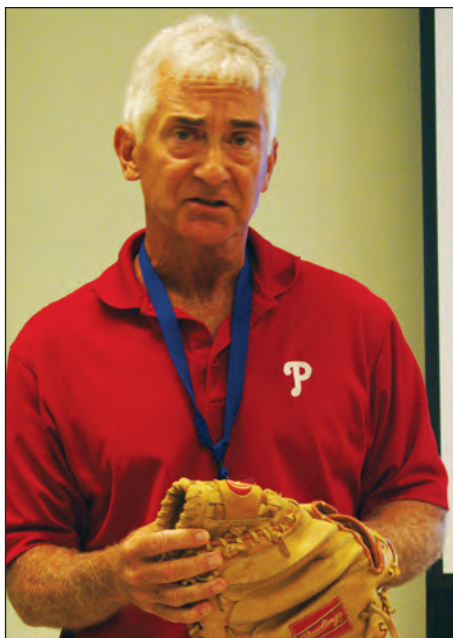

LARRY KLEPNER



## COMPUTER SCIENCE

### CS110 21ST CENTURY SECURITY

Tuesdays, 2:30 p.m.–3:45 p.m.

Dates: 5 Sessions, February 23–March 22

Facilitator: Susan McLaughlin

We live in a remarkable world, propelled forward by rapid advances in technology. The thought of “keeping up” can often be overwhelming. In this five week series, perspectives on security will be presented from a variety of speakers on the following topics: cybersecurity, safe browsing habits, responsible digital citizenship, mobile device security, the “Internet of things,” home security, identity theft and consumer fraud.

**Class is limited to 28 students.**

### CS386 COMPUTER USERS' WORKSHOP

Thursdays, 2:30 p.m.–3:45 p.m.

Dates: 10 Sessions, February 25–April 28

Facilitator: Larry Watkins

This workshop is designed to be an opportunity for computer users of all levels to get together and share experiences, troubleshoot problems and learn new things in an informal group environment. The content will be driven primarily by participants, so please bring your ideas, stories and questions with you! A laptop or tablet of your own is recommended, though some computers will be available for use. Possible topics include options for managing passwords, a hands-on look inside of the computer and its components, Linux and “alternative” software, a look back at the history of computing and a look forward into the future. No particular skills are required to participate, just genuine interest and curiosity to learn new things. **Class is limited to 25 students.**



## ECONOMICS/ FINANCE

### EC121 ELDER LAW

Thursdays, 10:30 a.m.–11:45 a.m.  
5 Sessions, February 25–March 24  
Instructor: John Grady

This course will cover various topics related to elder law, including wills, estates, trusts, powers of attorney, treble damages, social security and civil rights. **Class is limited to 28 students.**



## HISTORY

### HX151 EXPLORING THE HERITAGE OF THE FIRST STATE

Wednesdays, 1 p.m.–2 p.m.  
Dates: 5 Sessions, March 30–April 27  
Facilitator: First State Heritage Park Staff

This course entails a series of visits to five historical sites in the First State Heritage Park: Old State House, John Bell House, Johnson Victrola Museum, Legislative Hall, and Woodburn/Hall House (governor's residence and guest house). Through the many tales of Dover's history, retold by period-dressed historical interpreters, participants in this course will come away with a deeper appreciation of the First State's rich heritage. **Class is limited to 25 students.**

### ★ *New!*

### HX153 THE GOLDEN AGE OF MUSIC

Wednesdays, 1 p.m.–2 p.m.  
Dates: 5 Sessions, February 24–March 23  
Facilitator: Division of Historical and Cultural Affairs

Join the historic interpreters at the Johnson Victrola Museum for this series of true stories of people and music that inspired a nation. Stories will include: "Over There: World War I and the Victor Talking Machine Company," "All That Jazz: From the Beginning," "Play that Old Time Country Music," "The Minstrel Boy: The Life of John McCormick," and "The Life and Times of Fats Waller." Sessions will take place on the second floor walk-up of the Johnson Victrola Museum, 375 South New Street in Dover. In conjunction with the Division's educational mission, this class will be open to the public. **Class is limited to 25 students.**

### ★ *New!*

### HX160 HISTORY OF AVIATION—PART I

Tuesdays, 9 a.m.–10:15 a.m.  
Dates: 10 Sessions, February 23–April 26  
Instructor: Ray Hain

This course will span several semesters and will cover the early history of aviation, and the people, places and ideas that brought the airplane to the modern age. There are many colorful characters who gave us some part of this history from inventing the airplane to actually flying them. The course will

consider the many military and civilian uses to which airplanes have been put. It will end with the space age. **Class is limited to 28 students.**

### ★ *New!*

### HX161 ON THE HOME FRONT

Thursdays, 2:30 p.m.–3:45 p.m.  
Dates: 10 Sessions, February 25–April 28  
Instructor: Kevin McGrath

Learn about the Americans who remained at home during World War II to include: the trials and hardship faced by "Rosie the Riveter," the internment of Japanese-Americans, the plight of African-Americans, Roosevelt's four freedoms, rationing and other issues faced by American civilians from 1939–1945. **Class is limited to 50 students.**

### HX211 THE ASSASSINATION OF JOHN F. KENNEDY

Thursdays, 10:30 a.m.–11:45 a.m.  
Dates: 10 Sessions, February 25–April 28  
Instructor: Dan Pritchett

The official verdict of the United States government about the assassination of President John F. Kennedy is, as the Warren Commission reported in 1964, that he was killed by a single gunman, Lee Harvey Oswald, acting alone, and shooting from the sixth floor of the Texas School Book Depository Building in Dallas. But it is only half true. The House Select Committee on Assassinations, which unquestionably conducted a more thorough investigation, reported in 1979 that the president's murder was "the result of a probable conspiracy." Over the years much information has come to light which engenders even more doubts about this crime, which can easily justify the assertion that it is the greatest unsolved mystery of the twentieth century. This class will take us back to 1963 and the horrific events of November 22, and examine some of the controversies, theories and mysteries about the traumatic event that changed the United States forever. **Class is limited to 50 students.**

## Gifts



While we calculate membership fees to cover our operating costs, we always have a need for additional and upgraded audiovisual equipment, computers and classroom teaching aids. Many of those items are paid from the Gift Fund. We are happy to receive your donation to the Gift Fund for a specific use or, preferably, unrestricted so your Council can focus them on our greatest needs. You can include a gift with your registration.



★ **New!**

**HX213 AND THE WORLD WAS NEVER THE SAME—PART II**

Tuesdays, 10:30 a.m.–11:45 a.m.

Dates: 9 Sessions, February 23–March 29,

April 12–April 26

Instructor: Bill Jones

During this term we will explore the turning points in history between the invention of the printing press and the Industrial Revolution. Using the Great Courses *The World Was Never the Same: Events That Changed History*, PowerPoint presentation and lecture, we will investigate the conquest of North and South America, the Protestant Reformation, medieval technology, the birth of the United States, the Industrial Revolution and other topics. **Class is limited to 50 students.**

★ **New!**

**HX214 CHINA IN WWII—THE SECOND SINO-JAPANESE WAR**

Tuesdays, 1 p.m.–2:15 p.m.

Dates: 10 Sessions, February 23–April 26

Instructor: Mike Appgar

The second Sino-Japanese war began in July 1937 and ended in August 1945. Many of us are knowledgeable about the fighting in North Africa, Western Europe and the Pacific during the war, but we do not realize how much the conflicts in China presaged events in other theaters of war and the outcome of the war itself. At times, China received military assistance and direct involvement from Nazi Germany, the Soviet Union and the United States and its European allies. The number of Chinese deaths may have exceeded those of any other country. The instructor will tell this story using images and films you have likely never seen. If you are interested in expanding your knowledge and appreciation of the entire global conflict, this course is for you. **Class is limited to 28 students.**

**Member Benefits**

- Register for as many classes as you like.
- Participate in Osher sponsored trips and events.
- Enjoy our lunchtime speaker series.
- On-site wireless Internet access.
- Audit one UD credit course in fall and spring semester on a space available basis without paying tuition. Does not include online/distance learning courses, Associate in Arts program, certificate programs or UD travel/study programs. All relevant fees apply.



★ **New!**

**HX216 WASHINGTON'S CROSSING: A DESPERATE THING TO DO?**

Thursdays, 9 a.m.–10:15 a.m.

Dates: 5 Sessions, February 25–March 24

Instructor: Elizabeth Jelich

By 1776 Washington had not been able to win any decisive battles. He always seemed to be outmanned and outgunned. Winter was upon him and his army certainly needed to rest and regroup. He felt he desperately needed to devise a decisive maneuver to infuse a sense of hope within his army and throughout the colonies. Times were becoming desperate for their cause. At this moment he felt desperate times called for desperate measures. What would be his desperate measure? Would his new plan be a desperate thing to do?? **Class is limited to 20 students.**

★ **New!**

**HX217 SELECTED TOPICS IN DELAWARE HISTORY**

Tuesdays, 9 a.m.–10:15 a.m.

Dates: 5 Sessions, February 23–March 22

Instructor: Terry Bryan

The instructor will describe aspects of Delaware history related to his long-time research and collecting interests. Slides and show-and-tell material will illustrate the talks. The first session will discuss the history of the boundaries of Delaware. **Class is limited to 28 students.**

**HX239 THE UNIQUE QUALITIES OF DELAWARE**

Thursdays, 1 p.m.–2:15 p.m.

Dates: 10 Sessions, February 25–April 28

Facilitators: ~~Caroline Baxter and Bill Burton~~

**CANCELED**

This course will explore the unique aspects of Delaware's culture, politics and environment. Using local authorities, the class will hear interesting details on major topics including Delaware's Native American population, agriculture, tourism—NASCAR to pumpkins, horseshoe crabs and migratory birds. **Class is limited to 28 students.**



LARRY KLEPNER



## HUMANITIES

★ *New!*

### HU101 IMAGES OF IDEAS

Tuesdays, 10:30 a.m.–11:45 a.m.

Dates: 10 Sessions, February 23–April 26

Instructors: James Greene and Kay Greene

The frameworks we use to perceive the world, to a great degree, determine how we act in it. Change the frameworks and we change how we act. If these statements are true, then the great questions of philosophy are essential for a fulfilled life. We will explore crucial ideas from art, science, economics and politics. We will discover why some of these ideas are mortal questions, literally life and death problems. We will use art, music, literature and metaphor to make these ideas easier to understand and remember. Perhaps some of these ideas will actually help change your framework, and therefore your life!

**Class limited to 28 students.**

### HU121 INTERESTING ISSUES IN CONSTITUTIONAL LAW

**RESCHEDULED to Tues. 9–10:30**  
Thursdays, 10:30 a.m.–11:45 a.m.

Dates: 5 Sessions, March 31–April 28

Instructor: Mary Boyd

A review and discussion of the philosophy and history behind the U.S. Constitution, including interpretations by the Supreme Court and amendments. This course takes a macro/micro approach to our founding documents and includes various interpretations by authors and commentators. Each course highlights a different aspect of constitutional thinking and is unique in itself. The goal is to widen one's thinking relative to facts and context as participants in representative government. **Class is limited to 25 students.**

★ *New!*

### HU186 NINE GREAT RELIGIONS—PART I

Thursdays, 9 a.m.–10:15 a.m.

Dates: 10 Sessions, February 25–April 28

Instructor: June Cella

In this two-term course, we will examine aspects of nine great religions, including origins, sacred texts, concepts of deity, sects, basic beliefs and practice. Part I will include the Eastern religions Daoism, Hinduism, Jainism and Buddhism. Part II will focus on Judaism, Christianity, Islam, Sikhism and Mormonism. **Class is limited to 25 students.**

★ *New!*

### HU202 TALKIN' BASEBALL II—THE RICHNESS OF AMERICA'S NATIONAL PASTIME IN OUR LIFETIME

Thursdays, 1 p.m.–2:15 p.m.

Dates: 10 Sessions, February 25–April 28

Instructor: Randy Ward

"Baseball, it is said, is only a game. True. And the Grand Canyon is only a hole in Arizona. Not all holes, or games, are created equal." (George Will) America's national pastime is steeped in history, and 10 weeks doesn't cover many of the people and topics men and women of a certain age have experienced. This session features baseball characters, celebrities, books, movies, music, media, speakers and YOUR experiences covering the last half of the 20th century into the present. Is it done? "It ain't over 'til it's over." **Class is limited to 28 students.**

★ *New!*

### HU212 THE SEVEN DEADLY SINS

Thursdays, 10:30 a.m.–11:45 a.m.

Dates: 10 Sessions, February 25–April 28

Instructor: Bob Heifetz

Pride, envy, anger, sloth, greed, gluttony, (last but not least) lust. Have you ever wondered how great authors might write about those "sins"? Writers such as Faulkner, Wharton, Chekhov, Lawrence, Carver and others have tackled those topics in memorable short stories. Taking a Great Books text as our guide, we will explore the topic of sin in all it's glory. Text: *The Seven Deadly Sins Sampler*, [www.greatbooks.com](http://www.greatbooks.com), \$19.95, 1-800-222-5870. **Class is limited to 28 students.**



## Books and supplies

Most courses do not require purchased books or supplies. Course descriptions list textbooks and other supplies if suggested for the course. The cost of these materials is the responsibility of the student.





## Travel

### A Day on the National Mall • D.I.Y. day trip April 25, Washington, D.C.

Trip includes bus transportation and gratuity to the National Mall, Memorials Monuments and Smithsonian Museums.

Itinerary and lunch are entirely up to you—the possibilities are endless! For more information on the National Mall, Memorials and Monuments, visit [nationalmall.org](http://nationalmall.org). For more information on the Smithsonian Museums, visit [si.edu/Museums](http://si.edu/Museums). Cost: \$30 for members, \$35 for guests

### ★ *New!*

#### HU213 *A STREETCAR NAMED DESIRE—A RIDE INTO A NEW AMERICA*

Thursdays, 9 a.m.–10:15 a.m.  
Dates: 5 Sessions, March 31–April 28  
Instructor: Bob Heifetz

Come along on *A Streetcar Named Desire!* See how this play reflects post World War II America. Let us visit with Tennessee Williams, Elia Kazan and Marlon Brando. Let us discuss how that trio introduces us to a new nation, a nation transformed by years of economic hardship and world war. **Class is limited to 28 students.**

### ★ *New!*

#### HU229 CONVERSATIONS ON POETRY

Thursdays, 10:30 a.m.–11:45 a.m.  
Dates: 5 Sessions, March 31–April 28  
Instructor: Gail Johnston

Mary Oliver and Linda Pastan are two contemporary poets who write about life, its pain and pleasure, in different ways. Mary Oliver, winner of a Pulitzer Prize for poetry, uses the natural world as a focus for much of her examination. Linda Pastan focuses on people and relationships in exploring life's transitions. We will be reading and discussing several poems by each poet, looking at their use of words and imagery to describe the miracles of

everyday living. **Class is limited to 14 students.**

### ★ *New!*

#### HU242 THE POETICS OF *MOBY DICK*

Tuesdays, 1 p.m.–2:15 p.m.  
Dates: 5 Sessions, February 23–March 22  
Instructor: Russell Endo

Harold Bloom has called Herman Melville's *Moby Dick* a poetic work, and Melville himself most prided himself on his poetry, but, as we all learned in *Moby Dick*, in life, things turn out differently, don't they? This semester, our class will focus on chapters and passages in this great American novel, with a keen eye (and "keel") for its poetry. We will explore Melville's intentions and inadvertencies embodied in his poetic writing in *Moby Dick*, and also perhaps see what Bloom calls in *Moby Dick*, the "daemon within." **Class is limited to 15 students.**



LARRY KLEPNER

## LANGUAGE

### ★ *New!*

#### LA115 BEGINNING CONVERSATIONAL SPANISH

Tuesdays, 2:30 p.m.–3:45 p.m.  
Dates: 5 Sessions, March 29–April 26  
Instructor: Julie Price

Students will learn the basic rules of Spanish pronunciation, how to meet and greet others, how to ask for directions and how to express needs (e.g., hunger, thirst) as well as likes and dislikes. There will also be some cultural content. **Class is limited to 15 students.**

### ★ *New!*

#### LA207 FRENCH CUISINE—MERINGUE OR MACAROONS?

Tuesdays, 10:30 a.m.–11:45 a.m.  
Dates: 8 Sessions, March 8–April 26  
Instructor: Alice Cataldi

Participants in this class will enhance their communicative skills in French using regional French cuisine as the context. They will acquire vocabulary and phrases pertaining to food and cooking. They will also become familiar specifically with the regions of Provence, Normandy and Burgundy and their culinary specialties. Participants will prepare foods and demonstrate their preparation to the class. Intermediate level communicative skills in French required. **Class is limited to 15 students.**

★ **New!**

## LA208 LET'S MEET THE FRENCH!

Tuesdays, 9 a.m.–10:15 a.m.  
Dates: 8 Sessions, March 8–April 26  
Instructor: Alice Cataldi

An imaginary trip through various regions of France will serve as the context for enhancing language skills. The participants in this class will become familiar with the geography, history and landmarks of the places they visit. In turn, they will present their ideal itinerary to the class and explain the reasons for their choice. Two semesters of French at the Osher Lifelong Learning Institute, or the equivalent, are recommended.

**Class is limited to 15 students.**



## LIFE SKILLS

★ **New!**

## LS101 THE LEGACY OF LIFELONG LEARNING

Wednesdays, 1 p.m.–2 p.m.  
Dates: 5 Sessions, February 24–March 23  
Instructor: Tim Plimpton

This course is designed for enthusiastic OLLI members, instructors and volunteers who wish to peer deeper into the heart of the modern lifelong learning movement in the United States, with particular attention given to Osher endowed institutes. Perspectives from published research will include breadth of motivations, historical evolution and degrees of localism in programs. **Class is limited to 28 students.**

★ **New!**

## LS120 WRITING OBITUARIES

Tuesdays, 10:30 a.m.–11:45 a.m.  
Dates: 10 Sessions, February 23–April 26  
Instructor: Margaret McKay

If you want to make sure that your obituary will do justice to your contributions to the world, the only way you can be certain is to write it yourself. This course is designed to help you ask the right questions about the deceased and predeceased, research any information you don't already have about your loved one or yourself, and reflect on the contribution that person gave to the world. Recommended texts: *ObitKit—A Guide to Celebrating Your Life*, ISBN-13: 978-0615390543, and *Obit: Inspiring Stories of Ordinary People Who Led Extraordinary Lives*, ISBN-13: 978-0143113836. **Class is limited to 15 students.**

## LS140 WRITER'S CRITIQUE WORKSHOP

Thursdays, 9 a.m.–10:15 a.m.  
Dates: 5 Sessions, March 31–April 28  
Instructor: Gail Johnston

Classroom workshop for writers with some writing experience in the reminiscence genre. Focus on critiquing skills, with class presentation of writing pieces, as well as critiquing work of others. Class discussions and participation, as well as brief reviews of writing techniques by instructor. **Class is limited to 10 students.**



## Instructor Discount

Instructors are offered a membership discount of \$15 per semester. The discount may only be applied in the semester you are teaching. Two semesters of the discount (\$30) may be applied to a full year membership provided that you teach in both the fall and the spring.



## Guests

Visitors and prospective members who wish to become familiar with our program are welcome to visit on a single day. Please visit the office to pick up an ID badge. Auditing classes for the day is encouraged given available classroom space and approval from the instructor(s).





## PERFORMING ARTS

### PA104 FUN WITH THE UKULELE

Tuesdays, 9 a.m.–10:15 a.m.  
Dates: 5 Sessions, March 29–April 26  
Instructor: Don Blakey

Have fun learning to play the ukulele, led by “Ukulele Don” Blakey. There is no advanced knowledge needed for this course. Instructor has a few ukuleles for class use. **Class is limited to five students.**

### PA116 RECORDER ENSEMBLE

Tuesdays, 10:30 a.m.–11:45 a.m.  
Dates: 10 Sessions, February 23–April 26  
Instructor: Carol Neild

Students will continue their progress and increase their skill in playing the recorder. Class will cover folk music as well as music of the Renaissance and Baroque periods. Prerequisite: Students should have taken a past semester’s recorder class or have equivalent proficiency on the recorder. **Class is limited to 15 students.**

### PA118 SING ALONG WITH BROADWAY MUSICALS

Thursdays, 1 p.m.–2:15 p.m.  
Dates: 10 Sessions, February 25–April 28  
Instructor: Sue Letavish

If you love Broadway musicals and singing, you will love this class. After a brief presentation, we will drop the needle on an album and sing along with some great music. Some of the shows will include “Showboat,” “Oklahoma,” “West Side Story” and “The Music Man.” **Class is limited to 35 students.**



## PSYCHOLOGY/ SOCIAL STUDIES

★ *New!*

### PS108 THE “ELEPHANT” HAS LEFT THE BUILDING

Tuesdays, 1 p.m.–2:15 p.m.  
Dates: 10 Sessions, February 23–April 26  
Instructors: George Christensen and Steve Kotrch

An update of their course Dealing with the Elephant in the Closet (2013–14), the instructors re-examine the experience of the LGBT community in modern times with emphasis on changes in the law and public attitudes in America toward homosexuals and homosexuality. **Class is limited to 28 students.**

### PS111 OUR NATIONAL PARKS—PART II

Tuesdays, 9 a.m.–10:15 a.m.  
Dates: 9 Sessions, February 23–March 29, April 12–April 26  
Instructor: Bill Jones

Using lecture, PowerPoint and DVDs, we will journey through the National Park system, looking at the parks from the point of view of geologists, biologists, naturalists, park rangers and tourists. The PowerPoint portions of the lectures include photographs taken by the instructor and his wife. Many of the lectures have been updated and some new lectures have been added. This is a three term course. **Class is limited to 50 students.**



LARRY KLEPNER

### PS121 HOW WE STUDY HUMAN BEHAVIOR

Thursdays, 2:30 p.m.–3:45 p.m.  
Dates: 10 Sessions, February 25–April 28  
Instructor: Roger Hazzard

Do you sometimes just like watching people to see what they do? Talk about a cheap form of entertainment! But there is more to it than that. While the study of human behavior may begin with observation, it is not the be-all-end-all of understanding behavior. In this class we will look at several approaches that have been used to study human behavior. We will start with the underpinnings of types of research—the old heredity vs. environment question. We will then take a look at research models used throughout the years, ethics in research, do a little bit of math (to show that there are some things we can know and some things we CAN know!), the biological basis of understanding behavior, developmental processes—both physical and cognitive through our years, personality development and social psychology. **Class is limited to 28 students.**

## Inclement weather

Classes are canceled whenever Modern Maturity Center activities are canceled due to inclement weather. Please visit [lifelonglearning.udel.edu/dover](http://lifelonglearning.udel.edu/dover) for weather updates or cancellations, or call the Osher office at 302-736-7450.





## RECREATION

### RR101 EXPLORING BOMBAY HOOK

Wednesdays, 10 a.m.–12 p.m.

Dates: 5 Sessions, March 30–April 27

Instructor: Janet Manchester

Each week, participants will board a 12-passenger van and spend two hours exploring the refuge. The group will walk short trails and climb observation towers if they are able. We will look for wildlife and discuss the habitat and management practices at the refuge. Class will meet in the visitor center parking lot at Bombay Hook. **Class is limited to 12 students.**

### RR102 CHAIR AEROBICS

Wednesdays, 11 a.m.–12 p.m.

Dates: 9 Sessions, March 2–April 27

Facilitator: Jan Miller

This video-based chair aerobics class involves the use of light hand weights, stretch bands, canes, towels and medium sized beach balls. There will be stretches and joint manipulation to combat the pain of arthritis. Most exercises are set to music. There is an increase in serotonin and adrenaline. Expect to have fun! **Class is limited to 12 students.**



## SCIENCE/HEALTH MATH

★ *New!*

### SS110 THE AGING MIND

Wednesdays, 1 p.m.–3 p.m.

Dates: 5 Sessions, March 30–April 27

Instructor: Jamie Magee

Learn the basics of Alzheimer's and dementia, the 10 warning signs, what causes behaviors, how to communicate and tips for maintaining overall health. PowerPoint, lecture and discussions will be used. **Class is limited to 28 students.**

### SS155 HOW YOUR BODY WORKS AND HOW IT AGES

Tuesdays, 1 p.m.–2:15 p.m.

Dates: 10 Sessions, February 23–March 29, April 12–May 3

Instructor: Art McLaughlin

This course will present the anatomy and physiology of the human body systems, which will include the heart, blood and circulatory system; the skeletal system; the muscular system; the sensation system, which includes the eye, ear and the sense of touch; the digestive system; and the urinary system. Each class will begin with a presentation of the anatomy and normal function of each system, followed by discussion of the effects of aging. **Class is limited to 50 students.**

## Special Speaker Thursdays

Noon–12:50 p.m.

Join us on Thursdays for interesting special speakers on a wide array of topics. These programs are free for members. You are welcome to attend every program or select the ones that most interest you. Bring a lunch and enjoy! *Schedule is subject to change*

**February 25**—What's Happening in Dover—*Mayor Robin Christiansen*

**March 3**—Climate Change and the Impact on Delaware's Coastline—*Dr. Susan Love*

**March 10**—Criminal Justice and the Prison System in Delaware—*Patrick Ryan*

**March 17**—Historic Byways in Delaware—*Michael Hahn, DelDOT*

**March 24**—Is Our Food Safe to Eat?—*Ralph Matthews, Div. of Public Health*

**March 31**—Living With Long-term Loss—*Sondra Satterfield, Delaware Hospice*

**April 7**—"These Are a Few of My Favorite Things"—*Terry Bryan*

**April 14**—Feeding the Needy—*Pat Beebe, Delaware Food Program*

**April 21**—Volunteerism—*Miss Delaware Brooke Mitchell*

**April 28**—to be announced



---

# Spring 2016 Instructors

**Mike Apgar** received an A.B. in geology from Rutgers and an M.S. in geology-geochemistry from Penn State. After a career as a geologist focused on groundwater issues in both consulting and in government roles, Mike has continued to pursue his interests in geology, history and religion in retirement.

**Caroline Baxter** is a retired public employee with a degree in business administration. A native Delawarean, Caroline has always had a keen interest in its history.

**Don Blakey** is a retired public school administrator and university educator with more than 50 years of service in Delaware. He and his wife Dolores are the founders of DonDel Enterprises, Inc., a children's theatre company. A world traveler, Don specializes in life in East Africa, especially Kenya and Tanzania. His hobbies include writing, photography, languages and playing the ukulele.

**Terry Bryan** is a dentist with a mobile practice to nursing care facilities, and a lifelong Delaware resident. He is a past member of several Delaware medical committees and current member of several numismatic and historical-interest organizations. Terry is a member of the Dover Symphony Orchestra, the Milford Community Band and other music groups. He is a dedicated collector of Delaware ephemera and antique sheet music and a frequent speaker on Delaware history topics. A number of his numismatic articles have appeared in national journals. He has presented previous Osher courses in Dover and Lewes.

**Bill Burton** retired to Dover, Delaware over two years ago after stints as an elected official in the suburbs of New York City, owner of a small publishing company, and as a printer. He collects local history, especially postcards and photos, and still watches and participates in local politics.

**Mary Boyd** is an attorney and teacher of U.S. constitutional and education law. Her background includes business and finance and historic preservation.

**Alice Cataldi's** first language of literacy is French. As such, she is passionate about the subject matter she has taught for many years. She retired from the University of Delaware where she taught French and trained future teachers of languages. In addition to promoting the French language and culture, Alice enjoys travel, visiting museums, reading, gardening and cooking ethnic meals for family and friends. She is the recipient of numerous teaching and advocacy awards. In recognition of her contributions to the promotion of the French culture and language, the French government named Alice a Chevalier Knight of the Academic Palms.

**June Cella** is a retired nurse educator. June holds a B.S.N. from Villanova University, an M.S.N. from the University of Pennsylvania, and an Ed.D. from Temple University.

**George Christensen** received a B.A. (University of Hawaii) 1972, M.A. (University of Delaware) 2012. Enlisted in the U.S. Navy in 1956 and completed 23 years' active duty, retiring in 1979 as a lieutenant commander. George worked for 10 years (1991–2001) as an R.N. in an acute care setting for hospice

AIDS patients. He and his spouse, Steve, have lived in Dover for 14 years.

The **Division of Historical and Cultural Affairs** is committed to preserving Delaware's heritage and showcasing the historic legacy of our state. Through active historic preservation efforts, engaging educational programs, stimulating exhibits and superior customer service, the Division is committed to enhancing Delaware's quality of life by helping people connect with those aspects of our past that have made this state what it is today.

**Kathleen Dunn** is a retired teacher of home economics, computer programming and technology. During the height of the space shuttle program, she taught a graduate school course for educators in aerospace education at the University of Alabama in Huntsville. She also was technology coordinator for a Delaware school district and Delaware's Christa McAuliffe Fellow for a project that introduced image processing to Delaware schools. She has been teaching knitting for 46 years and especially enjoys cabled and ski sweaters or lace. She also creates her own patterns. Her retirement project is to earn the Master Hand Knitter certificate from the Knitting Guild Association. About 300 knitters worldwide have achieved this level of proficiency. Kathleen is about two-thirds of the way there.

**Russ Endo**, a professional poet, received his B.A. in combined literature from Yale College. He obtained a juris doctor from the University of Pennsylvania Law School. Russ has been published in many publications

including *Journal of Biological Chemistry*, *American Friends Delegation Report on China after Tiananmen Square*, *American Poetry Review*, *The Antioch Review*, *Ploughshares* and *The Philadelphia Inquirer*. His poem "Susumu, My Name" was the basis for a jazz orchestration by Sumi Tonooka that appeared on PBS. He currently sits on the boards of Wilmington Friends School and Greene Street Friends School in Philadelphia.

The **First State Heritage Park at Dover** is Delaware's first urban park without boundaries, linking historic and cultural sites in the city that has been the seat of state government since 1777. It is a partnership of state and city agencies under the leadership of Delaware State Parks. Tours are led by historical interpreters in period dress who uncover many tales from Dover's history.

**John Grady** graduated from St. Joseph's University in 1966 and Georgetown University Law Center in 1969. He was admitted to the Supreme Court of Delaware in 1969. He has litigated in all the state and federal courts in Delaware, Pennsylvania and the District of Columbia. He is of counsel with Grady and Hampton. His areas of interest were personal injury, civil rights, real estate, wills and estates, and social security.

**James and Kay Greene.** Jim taught the history of ideas at a very progressive school in New York City. Kay taught 6th grade science in Milford. Both love ideas, folly, bad logic and laughter. We will provide the cookies; you should provide your versions of the world.

**Ray Hain** is a retired Air Force officer and a retired engineer for a major aerospace company. His time in the Air Force was spent on active duty as a

pilot and in the reserve as an engineer. Ray has been interested in airplanes since he was 12. He holds a B.S. in aeronautical engineering, an M.A. in military studies in airpower and an M.A. in philosophy. Ray has been involved with aerospace for 40 years.

**Roger Hazzard** received a B.A. in political science from American University in D.C. and an M.A. in psychology from Washington College in Chestertown, Md. He taught in the social studies department at Dover High School for 30 years. He also taught psychology and human development at Delaware Technical Community College Terry Campus, and general psychology for the University of Delaware.

**Bob Heifetz** received a B.A. in English/education and an M.A. from Queens College. He taught high school English in New York for five years and in Connecticut for 25 years, the American literature honors program for over 20 years, and English electives such as creative writing. Bob has participated in numerous poetry and book groups and taught the Bible as literature to church and synagogue adult groups. His hobbies include bicycling, hiking, kayaking and bird watching. He enjoys traveling and spending time with family and friends.

**Elizabeth Jelich** is a graduate of Wesley College and the University of Delaware where she earned her bachelor's and master's degrees. Her deep Delaware roots enabled her to become a charter member of a local chapter of the Daughters of the American Colonists. During her 31 years of teaching, her passion was to instill in her students a lifelong love of history. Her teaching mission was to construct a classroom where history came alive.

**Gail Johnston** was born in Baltimore, Md., and lived there most of her adult life. She graduated from the University of Maryland with degrees in sociology and English literature and later obtained her graduate degree in social work. Although she worked for many years as a geriatric social worker, she always felt writing was her true avocation. She especially enjoys poetry, journaling and personal essay. After retiring, she wrote and published a memoir of her childhood, *Make a Lot of Noise and Don't Go on the Porch*. In 2009, she published a collection of poetry and essays, *Early Evening*. Some of her poetry and essays have appeared in the *Delmarva Quarterly* and other local publications. Astrology and enneagram interpretations have been hobbies for some time.

**Bill Jones** is a graduate of Cornell University. He worked at DuPont for 31 years, first as an auditor and later in supply chain management. After retirement from DuPont, he worked with three consulting firms before managing his own change management consulting company. Now finally retired, Bill and his wife Dot travel extensively. Besides the travel, Bill enjoys our natural environment, reading and history.

**Steve Kotrch** received a B.S. in business and management from the University of Maryland, University College. He served for four years in the U.S. Navy and sixteen years in the Air Force, retiring as a master sergeant. Steve received an A.A. degree in administrative management from the Community College of the Air Force. His hobbies include community theatre, learning piano, travel and reading. Steve lives in Dover with his spouse of thirty plus years, George.

---

**Sue Letavish** has been a musician all her life. She started with piano at age four, which she followed with learning the cello and singing in church and school choirs and has played handbells for almost 30 years. Sue has been retired from the field of speech/language pathology for 15 years. Sue has been an active member of the Dover Osher program since 2013. One of her drawings won a people's choice ribbon at the first annual statewide Osher art exhibit in 2015.

**Jamie Magee** graduated from Salisbury University in 1999 with a B.A. in social work and a minor in gerontology. She was hired as the social worker for the dementia unit at Life Care at Lofland Park in June 1999 and left July 2001. She opened the only office of the Alzheimer's Association in Sussex County, Delaware in September 2001 and works as the program coordinator for the Delaware Valley Chapter.

**Janet Manchester** received a B.A. in French from the University of Delaware and an M.S. in environmental science from Drexel University. Janet retired from the Delaware Department of Natural Resources and Environmental Control, where she worked as an environmental scientist. She has been a long-time volunteer at Bombay Hook National Wildlife Refuge and has served as president and a board member of the Friends of Bombay Hook.

**Kevin McGrath** received a B.A. in history from Mt. Carmel College, Niagara Falls, Ontario. He retired as a human resources management professional, and has held management positions with ITT, Nortel Networks and Comshare. His interests include American history and reading.

**Margaret (Mickey) McKay** is a retired professor of political science. She taught at the University of California, The State University of New York and the University of Texas prior to teaching at Delaware State University, from where she retired. Dr. McKay has previously taught American politics classes at the Osher Lifelong Learning Institute. Her other interest has been genealogy research of her German and Irish ancestors. This activity piqued her interest in obituaries as a form of recording the lives and experiences of her ancestors. Often these historical obituaries contained more information about the ancestor than contained in their public records. She also discovered that many people left this world without an obituary.

**Art McLaughlin** holds B.A.s in both political science and art history from the University of Delaware. He is currently a graduate student in art history at the University of Delaware. He also holds an A.S. in respiratory therapy and an M.S. in community health and wellness administration. In addition, he is author of six textbooks on medically-related topics and a National League for Nursing approved college instructor in science.

**Susan McLaughlin** received her bachelor's degree from the University of Delaware and a master of information sciences degree from the University of Pittsburgh. She worked as a systems analyst and programmer for the City of Pittsburgh before returning to Delaware. Susie has taught at Duquesne University, Robert Morris College, University of Pittsburgh and at Delaware Technical Community College for 22 years. She currently teaches courses at Wilmington University in the technology department.

**Linda Medunick** has attended Osher art classes from the first day they were offered. She has entered numerous juried art shows, won multiple ribbons and sold paintings. Her artistic journey has included the Norristown (Penn.) Art League; Brain Injury Association Art Club; Art Therapy Express Program, Inc.; Arts in the Estuary and the Biggs Museum of American Art. Linda was recently inducted into the National League of American Pen Women. This past year, Linda had a personal show and participated in a live showcase oil painting demonstration at the Dover Public Library. Her work was included in the first annual Statewide Osher Art Exhibit, and continues her enriching involvement in the Osher Dover program.

**Jan Miller** has over two years' experience teaching at the Osher Lifelong Learning Institute at the University of Delaware. She has 55 years of study and practice in painting, has taken many college level classes and has taught general and private lessons in various venues. Jan worked at the Peninsula Regional Medical Center and Johns Hopkins as a registered radiologic technologist. She retired from Unitrack Industries as a computer drafter and programmer.

**Carol Neild** is a retired elementary teacher/reading specialist. She has been active in musical activities since childhood, singing and playing several instruments from choirs, school band and orchestra to community symphony. Nearly 30 years ago she became involved with early music and has attended numerous workshops as well as Pinewoods and Amherst Early Music weeks. As a founding member of the Holly Consort, weekly rehearsals and a few gigs a year continue this interest.



**Tim Plimpton** is a native of Cherry Hill, N.J., and received his bachelor of music degree in trombone performance from the University of Delaware. He is the program coordinator of the Osher Lifelong Learning Institute at the University of Delaware in Dover. A lifelong learner at heart, he has studied physics, math, computer science, cybersecurity and has been an active church musician for six years. Tim's musical endeavors also include performing, teaching and writing music in the Delaware/Philadelphia area. Tim lives with his wife, Steffi, who is a professional vocalist and music teacher in Dover and with whom he performs frequently.

**Julie Price** has a B.A. in psychology from Antioch College and an M.A. in Spanish and English from the University of Cincinnati. She learned to speak Spanish in Spain and has also traveled and conducted research in Latin America. Currently retired, Julie has taught Spanish at all levels. In her spare time, she enjoys singing with the Delaware Choral Society.

**Dan Pritchett** received a B.S. in social studies education, Concord College, and an M.A. in American history, University of Delaware. Dan held a teaching position in the Capital School District, where he taught American history for 34 years. He later taught at Wilmington and Delaware State Universities. He is a member of the Lincoln Forum, one of the foremost national organizations dedicated to the study of Abraham Lincoln and his era.

**Liisa Trala** has a lifetime of artistic endeavors which include working as a draftsman doing detail and illustrations as well as a cake decorator (painting with icing). January 2012, Liisa took her first step, and signed up for an oil painting class. Just over a year later she entered the Delaware State Senior Art Exhibit and won a third place novice ribbon. Liisa has taught classes on beginning oil painting and decorative acrylics at the Osher Lifelong Learning Institute, Maime A. Warren Senior Center and the Dover Art League.

**Randall Ward** is a native Delawarean who enjoys people. He earned his B.S. and M.Ed. from the University of Delaware and was a Delaware educator for 34 years. He is passionate about many things and has been in love with baseball for almost as long as he can remember.

**Larry Watkins** is a retired software design engineer with over 30 years' experience in the design and installation of electronic systems containing embedded computers. Since retirement, he has been trained as a Master Gardener (University of Maine) and has done volunteer computer related work with Owls Head Transportation Museum, FIRST Robotics (as mentor for high school students), and the Delaware Division of Historical and Cultural Affairs. Larry has also built his own computer as a home media server.

**Andrew Zehnter** received an Associate's Degree in fine arts from Elizabeth Seton College in 1984. He attended courses at the School of Visual Arts in New York from 1984–1986. Andrew spent the next twenty years working in the graphic design and advertising field. Currently, he strictly paints watercolors for the joy of it.



## How to register

Have you tried online registration?  
[www.lifelonglearning.udel.edu/dover](http://www.lifelonglearning.udel.edu/dover)

- You may request as many courses as you like
- Request only the courses that you actually intend to take
- DO NOT request multiple courses in the same time slot
- Be sure to include the course code, course title and day/time for each class
- Rank your classes clearly **in order of priority** on Course Selection Form
- Courses have a limited number of seats, so use your top priorities wisely
- All course requests received by the priority deadline (**February 11**) will be allocated based on the priorities indicated.
  - Every effort will be made to accommodate everyone's first choice
  - Only after all priorities have been allocated, a computerized lottery will attempt to resolve any space conflicts.
  - The smaller the class limit the greater likelihood of a waiting list
  - If a class had a waiting list in the past, it probably will this semester as well
- Registrations received after the priority deadline (**February 11**) will be processed on a space-available basis.
- Course requests will not be processed until a membership fee is paid.
- Waiting list—Members who were not enrolled in a class during the previous semester because of over-subscription will be given preference this semester if the identical class is offered again. However, you must register for the class by the priority registration deadline and rank the class as your first priority on your registration form.

Mail the registration form to  
Osher Lifelong Learning Institute,  
1121 Forrest Ave, Dover, DE 19904.  
Online registration is available at  
[lifelonglearning.udel.edu/dover](http://lifelonglearning.udel.edu/dover).  
Additional forms may be obtained by  
visiting our website or by calling the  
office at 302-736-7450. In-person  
registration is also available in the  
Osher Dover Lifelong Learning Office  
at the Modern Maturity Center  
(Tuesdays and Thursdays, 9 a.m.–2 p.m.).  
Registration by telephone is not  
available.

## Spring 2016 Registration Form

### PLEASE CLEARLY FILL IN ALL INFORMATION

NAME (Please Print) \_\_\_\_\_

HOME PHONE \_\_\_\_\_ CELL PHONE \_\_\_\_\_

EMAIL \_\_\_\_\_

ADDRESS \_\_\_\_\_

CITY \_\_\_\_\_ STATE \_\_\_\_\_ ZIP CODE \_\_\_\_\_

DATE OF BIRTH \_\_\_\_\_

### IN CASE OF EMERGENCY OR ILLNESS CALL:

NAME \_\_\_\_\_

TELEPHONE \_\_\_\_\_ RELATIONSHIP \_\_\_\_\_

**EDUCATION:**  H.S.  Some college, A.A.  B.A., B.S., R.N.  M.A., M.S.  Ph.D., M.D., J.D.

**MEMBERSHIP DUES:**  New Member  Returning Member

\$\_\_\_\_\_ Spring Semester Membership \$130  I am a current full-year member

\$\_\_\_\_\_ Winter add-on to Spring \$20  \$\_\_\_\_\_ Winter add-on to full-year membership \$10

\$\_\_\_\_\_ Winter only membership fee \$30

\$\_\_\_\_\_ Donation to Scholarship Fund

\$\_\_\_\_\_ Donation to Gift Fund

\$\_\_\_\_\_ Instructor Discount –\$15

\$\_\_\_\_\_ Total (**Make check(s) payable to "University of Delaware."**) Check # \_\_\_\_\_

Credit Card:  American Express  Discover  MasterCard  VISA

Amount: \$\_\_\_\_\_ Credit Card No.: \_\_\_\_\_ - \_\_\_\_\_ - \_\_\_\_\_ - \_\_\_\_\_

Authorized cardholder signature: \_\_\_\_\_ Exp. date: \_\_\_\_\_

### NEW MEMBERS: HOW DID YOU LEARN ABOUT THE LIFELONG LEARNING PROGRAM?

Newspaper article  Newspaper ad  Friend  Library display  Radio ad  TV

Internet  Other \_\_\_\_\_

By submitting this form, I agree to hold the University of Delaware, its Trustees, officers, employees and agents harmless for any claims of personal injury or damage arising out of my association with the program or presence on the University campus, including any injury or damage arising as a result of the University's negligence. I authorize the University to record or photograph my image and/or voice for use by the University or its assignees in educational and promotional programs and materials.

**SIGNATURE REQUIRED** \_\_\_\_\_ **DATE** \_\_\_\_\_





## How to register

Have you tried online registration?  
[www.lifelonglearning.udel.edu/dover](http://www.lifelonglearning.udel.edu/dover)

- You may request as many courses as you like
- Request only the courses that you actually intend to take
- DO NOT request multiple courses in the same time slot
- Be sure to include the course code, course title and day/time for each class
- Rank your classes clearly **in order of priority** on Course Selection Form
- Courses have a limited number of seats, so use your top priorities wisely
- All course requests received by the priority deadline (**February 11**) will be allocated based on the priorities indicated.
  - Every effort will be made to accommodate everyone's first choice
  - Only after all priorities have been allocated, a computerized lottery will attempt to resolve any space conflicts.
  - The smaller the class limit the greater likelihood of a waiting list
  - If a class had a waiting list in the past, it probably will this semester as well
- Registrations received after the priority deadline (**February 11**) will be processed on a space-available basis.
- Course requests will not be processed until a membership fee is paid.
- Waiting list—Members who were not enrolled in a class during the previous semester because of over-subscription will be given preference this semester if the identical class is offered again. However, you must register for the class by the priority registration deadline and rank the class as your first priority on your registration form.

Mail the registration form to  
Osher Lifelong Learning Institute,  
1121 Forrest Ave, Dover, DE 19904.  
Online registration is available at  
[lifelonglearning.udel.edu/dover](http://lifelonglearning.udel.edu/dover).  
Additional forms may be obtained by  
visiting our website or by calling the  
office at 302-736-7450. In-person  
registration is also available in the  
Osher Dover Lifelong Learning Office  
at the Modern Maturity Center  
(Tuesdays and Thursdays, 9 a.m.–2 p.m.).  
Registration by telephone is not  
available.

## Spring 2016 Registration Form

### PLEASE CLEARLY FILL IN ALL INFORMATION

NAME (Please Print) \_\_\_\_\_

HOME PHONE \_\_\_\_\_ CELL PHONE \_\_\_\_\_

EMAIL \_\_\_\_\_

ADDRESS \_\_\_\_\_

CITY \_\_\_\_\_ STATE \_\_\_\_\_ ZIP CODE \_\_\_\_\_

DATE OF BIRTH \_\_\_\_\_

### IN CASE OF EMERGENCY OR ILLNESS CALL:

NAME \_\_\_\_\_

TELEPHONE \_\_\_\_\_ RELATIONSHIP \_\_\_\_\_

**EDUCATION:**  H.S.  Some college, A.A.  B.A., B.S., R.N.  M.A., M.S.  Ph.D., M.D., J.D.

**MEMBERSHIP DUES:**  New Member  Returning Member

\$\_\_\_\_\_ Spring Semester Membership \$130  I am a current full-year member

\$\_\_\_\_\_ Winter add-on to Spring \$20  \$\_\_\_\_\_ Winter add-on to full-year membership \$10

\$\_\_\_\_\_ Winter only membership fee \$30

\$\_\_\_\_\_ Donation to Scholarship Fund

\$\_\_\_\_\_ Donation to Gift Fund

\$\_\_\_\_\_ Instructor Discount –\$15

\$\_\_\_\_\_ Total (**Make check(s) payable to "University of Delaware."**) Check # \_\_\_\_\_

Credit Card:  American Express  Discover  MasterCard  VISA

Amount: \$\_\_\_\_\_ Credit Card No.: \_\_\_\_\_ - \_\_\_\_\_ - \_\_\_\_\_ - \_\_\_\_\_

Authorized cardholder signature: \_\_\_\_\_ Exp. date: \_\_\_\_\_

### NEW MEMBERS: HOW DID YOU LEARN ABOUT THE LIFELONG LEARNING PROGRAM?

Newspaper article  Newspaper ad  Friend  Library display  Radio ad  TV

Internet  Other \_\_\_\_\_

By submitting this form, I agree to hold the University of Delaware, its Trustees, officers, employees and agents harmless for any claims of personal injury or damage arising out of my association with the program or presence on the University campus, including any injury or damage arising as a result of the University's negligence. I authorize the University to record or photograph my image and/or voice for use by the University or its assignees in educational and promotional programs and materials.

**SIGNATURE REQUIRED** \_\_\_\_\_ **DATE** \_\_\_\_\_

# Course Selection Form

Please rank your courses in order of your priority

COURSE CODE	COURSE TITLE	DAY/TIME	MY PRIORITY(1,2,3,...)
_____	_____	_____	_____
_____	_____	_____	_____
_____	_____	_____	_____
_____	_____	_____	_____
_____	_____	_____	_____
_____	_____	_____	_____
_____	_____	_____	_____
_____	_____	_____	_____
_____	_____	_____	_____
_____	_____	_____	_____
_____	_____	_____	_____
_____	_____	_____	_____
_____	_____	_____	_____
_____	_____	_____	_____
_____	_____	_____	_____

Please indicate if you were previously waitlisted for your first priority course selection.  
Do not repeat any numbers when ranking your courses—this will jeopardize your assignments.

### VOLUNTEER OPPORTUNITIES

Because the lifelong learning program is a cooperative educational community, members have the opportunity and obligation to support its objectives through participation in committees, planning (courses, trips, activities) and serving as class leaders and instructors.

#### COUNT ON ME TO:

Teach or facilitate a course in \_\_\_\_\_

Serve on the following committee:  Curriculum  Public relations  Member relations  Special events  Travel

# Directions to Modern Maturity Center

## Osher Lifelong Learning Institute at the University of Delaware in Dover

Modern Maturity Center, 1121 Forrest Avenue, Dover, DE 19904  
302-736-7450

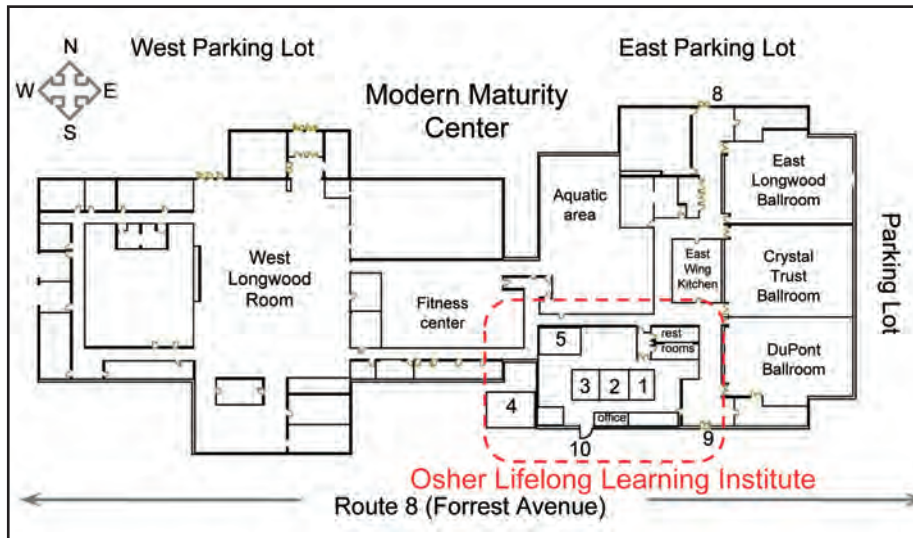

### From Route 1 Southbound:

- Take Exit 104 (US 13, Rt. 8, Scarborough Rd., N. Dover) on the right.
- Continue onto Scarborough Rd.
- Continue onto Rt. 15 (McKee Rd.)
- Turn right onto Rt. 8 (Forrest Ave.)
- Modern Maturity Center is on the right.
- Park in east section of parking lot and enter in front.

### From Route 1 Northbound:

- Take Exit 95 (Rt. 10 W Dover/Camden) on the right.
- Continue onto US 113 N. (S. Bay Rd.); street becomes US 13 N. (S. Dupont Hwy.)
- Turn left onto Rt. 8 (E. Division St.)
- Modern Maturity Center is on the right.
- Park in east section of parking lot and enter in front.

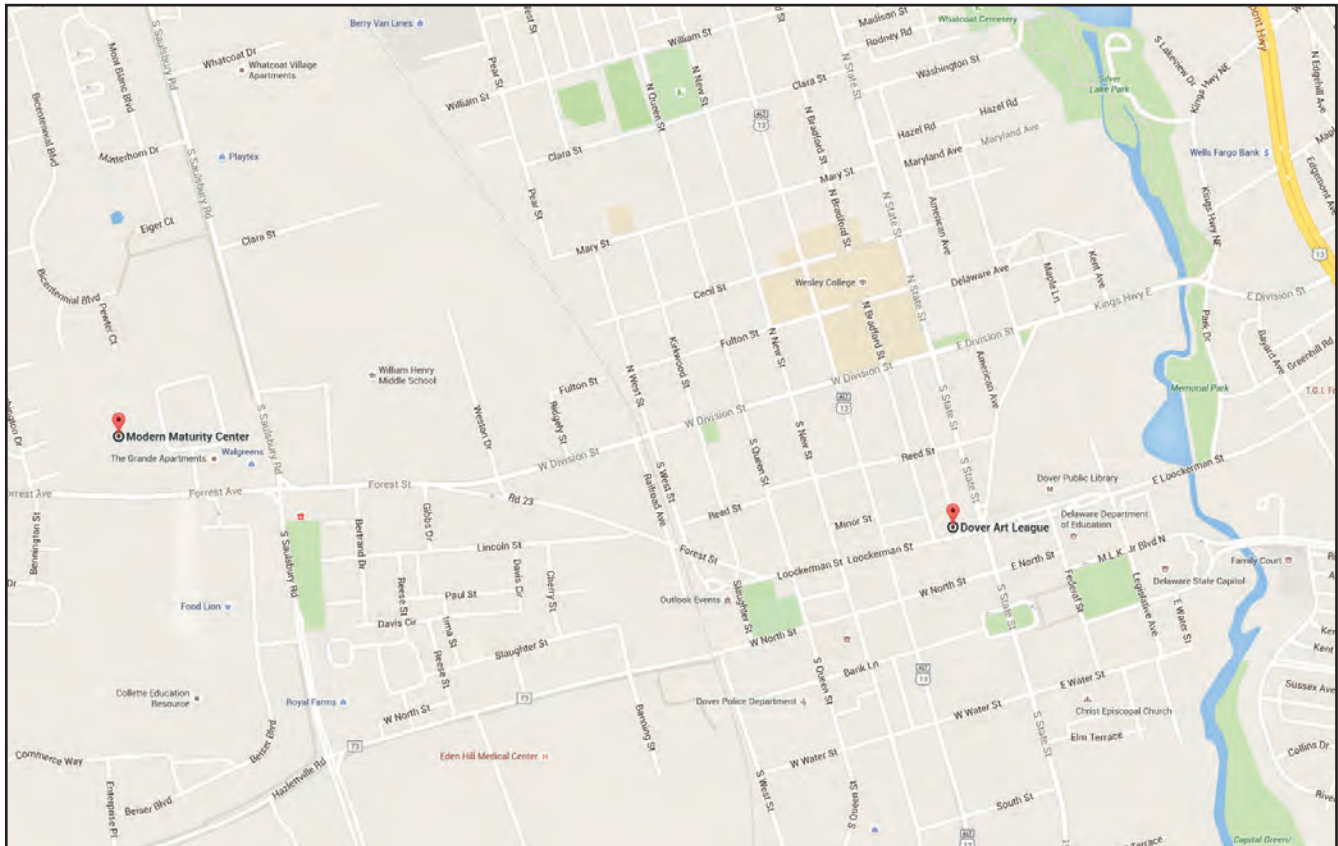





**Osher Lifelong Learning Institute  
at the University of Delaware in Dover**

1121 Forrest Avenue  
Dover, Delaware 19904

Nonprofit Org.  
**U.S. POSTAGE PAID**  
University of  
Delaware

**Winter/Spring 2016 Calendar**

**January 26–February 16, Tuesdays—**  
History of Painting with Watercolors series

**February 11, Thursday—**  
Priority registration deadline

**February 18, Thursday—**  
Instructor orientation, 9 a.m.–noon (MMC)

**February 23, Tuesday—**  
First day of classes

**April 22, Friday—**  
End of semester celebration, the Great Hall  
at St. Andrews, Dover

**April 25, Monday—**  
Bus trip to National Mall in Washington, D.C.

**April 28, Thursday—**  
Last day of classes

